

Threaded Rod for Swivel Feet ST M16x150, bright zinc-plated

Gewindestange ST M16x150, verzinkt kaufen ☐ - 3 842 537 232
kompatibel mit Bosch-Geräten. Jetzt sparen in unserem Onlineshop ☐ !

Product number ZB-3189

Weight 0.222kg

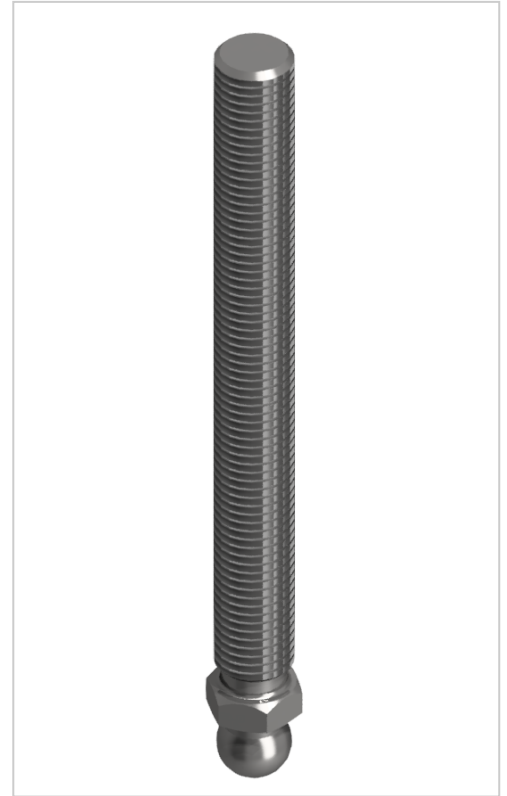

Product description

The combination of a threaded rod and a swivel foot plate gives a complete adjustable foot. Leveling feet serve as any type stepless height and level adjustment of modules and racks. The tilt of the plate is variable. Optionally, a rubber insert can be installed.

Product properties

Compatible with	Bosch
Part type	levelling feet
Series	Series 60-10, Series 45-10, Series 50-10, Series 40-10, Series 30 8, Series 20-6
Length	150 mm
Material	Galvanized steel
Thread	M16

More images

